

N A L A

ROAD 12M. WIDE

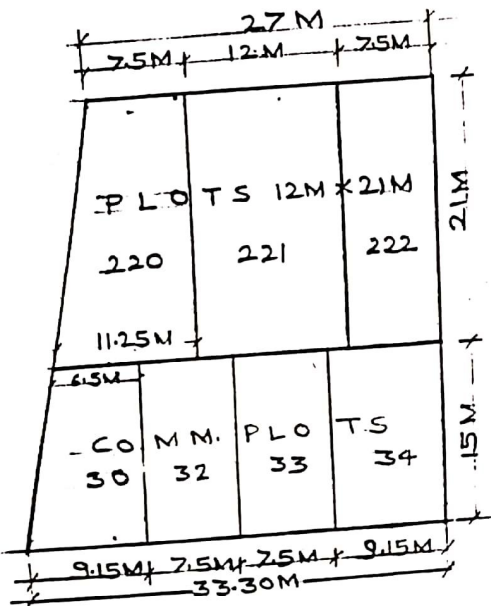

ROAD 48M WIDE

AREA OF COMM. PLOT NO. 30 = $\frac{6.5+9.15}{2} \times 15 = 117.375 \text{ SQM}$
 AREA OF COMM. PLOT NO. 32, 33 = $7.5 \times 15 = 112.5 \text{ SQM}$
 AREA OF COMM. PLOT NO. 34 = $9.15 \times 15 = 137.25 \text{ SQM}$
 AREA OF COMM. PLOT MISSING = 31
 AREA OF PLOT NO. 220 = $\frac{7.5+11.25}{2} \times 21 = 196.875 \text{ SQM}$
 " " " " 221 = $12 \times 21 = 252 \text{ SQM}$
 AREA OF PLOT NO. 222 = $7.5 \times 21 = 157.5 \text{ SQM}$

(NOTE) - SIT PLAN GIVEN MEASUREMENT BY JEN.
 ON NOTESHEET PARA. NO. 95 DATED 2/2/21

SITE PLAN OF PLOT NO. AT RESI-
 DENTIAL SCHEME RANBIRI AROGYA NAGAR
 KOTA

MEASURED BY <i>H. K. G. P.</i>	UT. DRG. NO. OF 2021
	SCALE 1CM = 5M.
DRAWN BY <i>S. M. R.</i>	ASST. TOWN PLANNER U.T.T. KOTA
T.P.A. J.I.T. KOTA 9/2/21	